



# STAY EXOTIC

## LOEWS ROYAL PACIFIC RESORT



ROOM AND SUITE SPECIFICATIONS GUIDE



Get swept away to a place filled with tropical wonders, exotic food and carefree fun. Delectably innovative food and drinks delight every palate. Mingle in a laid-back lounge in Polynesian paradise and leave the rest of the world behind.



UNIVERSAL ORLANDO™

## TABLE OF CONTENTS

- 3 Amenities
- 4 Standard Rooms
- 5 King Suites
- 6 Jurassic World Kids' Suites
- 7 Hospitality Parlor Suites
- 8 Royal Parlor Suites
- 9 Presidential Suites



## AMENITIES

- ▶ Complimentary wireless internet access in each guest room and most common areas of the hotel
  - Upgrade to Premium Plus wireless internet access for optimal entertainment and business needs (Fees apply)
- ▶ 300 thread count, 100% cotton bed linens
- ▶ Flat Panel Television including HD channels
- ▶ Smart room technology for automated heating and air conditioning
- ▶ iHome clock radios with iPod docking stations
- ▶ Coffee Maker
- ▶ Three telephones with dual voice lines, data port, and voicemail
- ▶ Mini-refrigerator
- ▶ In-room safe
- ▶ Iron and ironing board
- ▶ Separate bath and vanity area with two separate sinks
- ▶ Hair dryer and make-up mirror in the bathroom
- ▶ Cotton signature bathrobes
- ▶ Daily newspaper delivery upon request
- ▶ Complimentary turndown service upon request
- ▶ 24-Hour room service
- ▶ Rollaway beds upon request (Fees apply)
- ▶ Cribs complimentary upon request

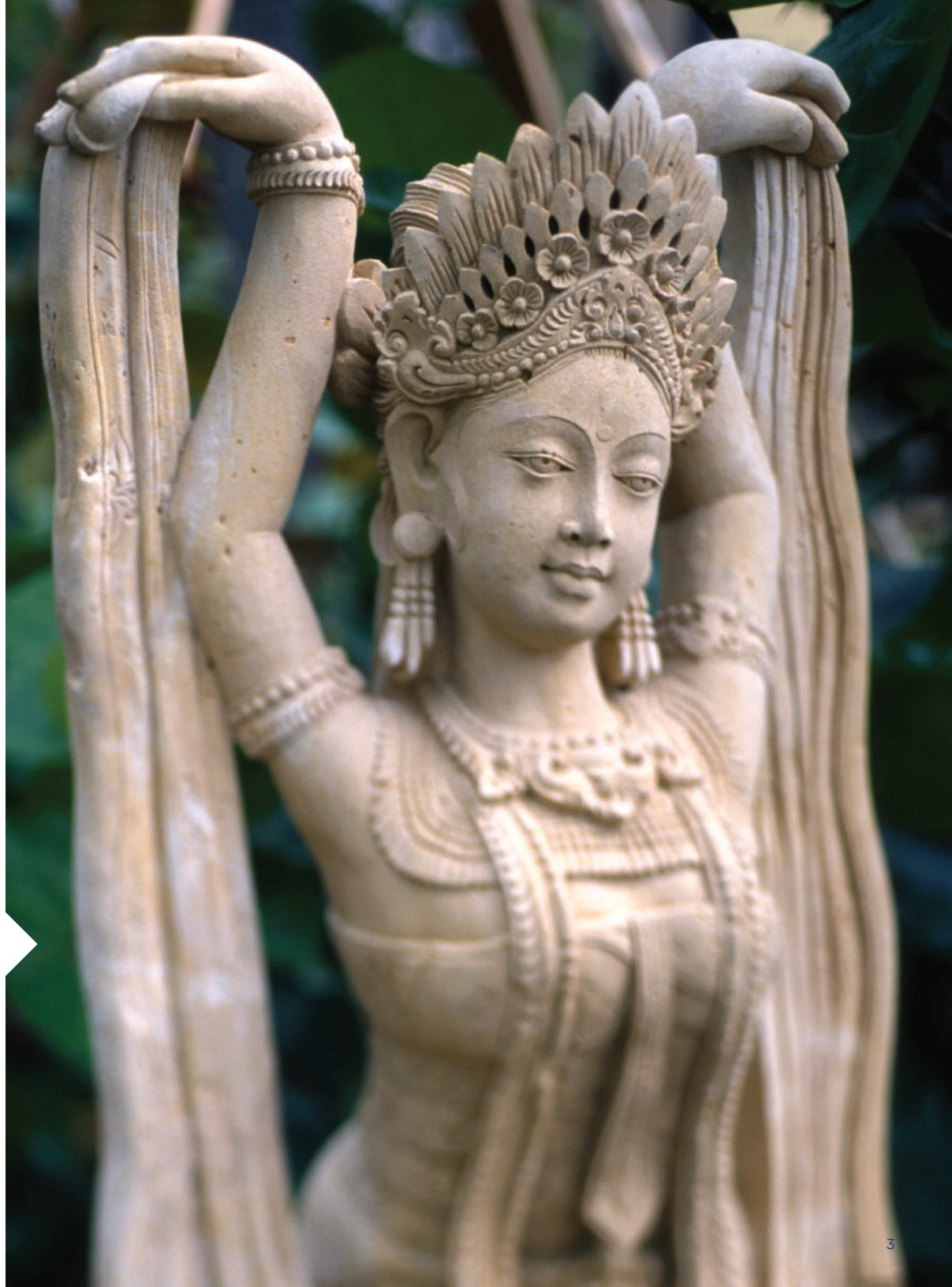



## STANDARD AND WATER VIEW ROOMS

- ▶ Approximately 335 square feet
- ▶ 899 guest rooms/50 club level rooms\*
- ▶ King or two queen beds
- ▶ King rooms accommodate 3 guests, queen rooms accommodate 5 guests.\*\*

\*Club access provided to select King and Queen rooms.

\*\*Maximum occupancies may require a rollaway for an additional fee.

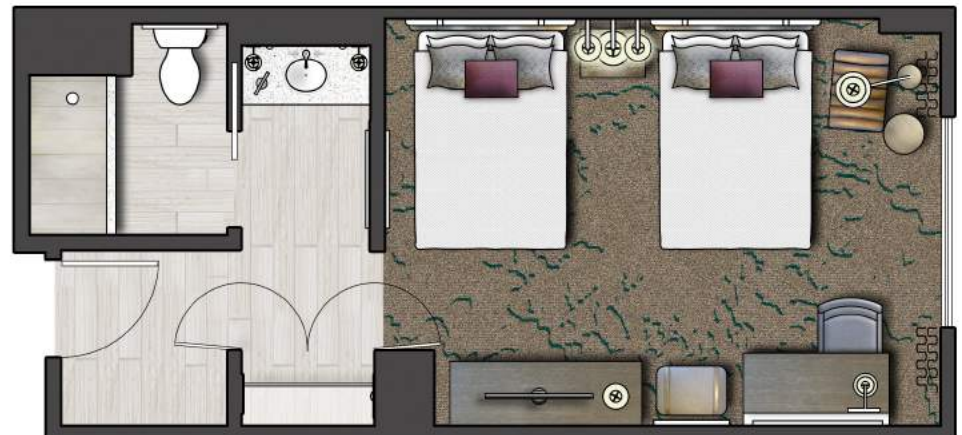



## KING SUITES

- ▶ Approximately 670 square feet
- ▶ 28 guest rooms
- ▶ King bed
- ▶ Separate living area with pull-out sofa
- ▶ Accommodates 4 guests (maximum of 3 adults)





## JURASSIC WORLD KIDS' SUITES

- ▶ Approximately 370 square feet
- ▶ 8 suites
- ▶ A standard king bedroom for adults connects to a separate room for the kids
- ▶ Children's room opens only into adults' room
- ▶ Accommodates 5 guests (maximum of 3 adults)\*

\*Maximum occupancies may require a rollaway for an additional fee.





## HOSPITALITY PARLOR SUITES

- ▶ Approximately 1,005 square feet
- ▶ 10 suites
- ▶ Connects to either King or Double Queen Standard or Water View Room
- ▶ Optional additional connecting King or Double Queen Standard or Water View Room
- ▶ Accommodates 5 guests\*\*

\*\*Maximum occupancies may require a rollaway for an additional fee.







## ROYAL PARLOR SUITES

- ▶ Approximately 1,005 square feet
- ▶ 3 suites
- ▶ Connects to either King or Double Queen Royal Club Room
- ▶ Optional connecting to King or Double Queen Royal Club Room
- ▶ Accommodates 5 guests\*\*

\*Convention and group bookings, defer to sales representative on configuration.

\*\*Maximum occupancies may require a rollaway for an additional fee.





## PRESIDENTIAL SUITES

- ▶ Approximately 1,340 square feet
- ▶ 2 suites
- ▶ King bed
- ▶ Up to two optional connecting Royal Club Rooms
- ▶ Accommodates 2 guests





STAY  
**AMAZED**



**LOEWS ROYAL PACIFIC RESORT**

6300 HOLLYWOOD WAY • ORLANDO, FLORIDA 32819

**LOEWS**  
HOTELS